

# PROCON™

## MINI SQUARE



### FEATURES

- Insertion loss <1,5 dB
- Temperature range  
57°C – +85°C
- Hermaphroditic  
interconnection
- Rugged connector design
- Keyed boot for blind  
mating
- No adaptors needed
- Easy clean, no special  
tools

### COMPATIBLE WITH

- FIBRECO - MINI 2
- QPC Q - MICRO
- TE PRO-BEAM - MINI
- TELECAST MX - MINI

The PROCON connectors offers a good attenuation. With an insertion loss of <1,5 dB it outperforms the NATO specification (<2,5 dB).

The PROCON Mini square is one of the smaller expanded beam connectors available on the market today. The low profile allows it to be used even in the most cramped environments and installations.

PROCON has the advantage of being produced inhouse in Åled, Sweden which also means a stable delivery performance and we are able to promise shorter leadtimes.

Like the other connectors in the Micropol PROCON expanded beam family, it is compatible with other mini sized expanded beam connectors on the market.

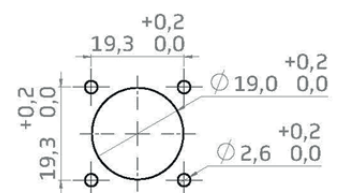
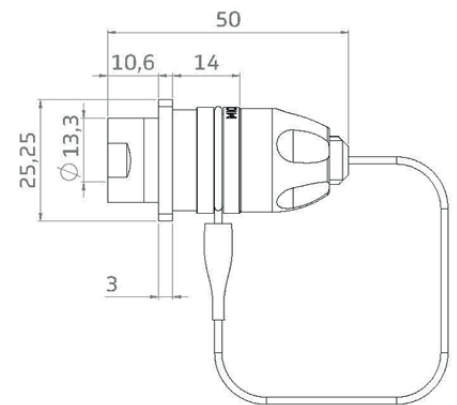

RECOMMENDED PANEL CUT-OUT

STANDARD CONFIGURATIONS

PROCON™ MINI	1 to 4 channels
--------------	-----------------

OPTICAL

Type	Single mode (SM), multimode (MM) or hybrid
Transmission	10Gbit/s
Insertion loss (SM)	Typical Insertion Loss -1,0dB (1310 nm) Maximum Insertion Loss -1,5dB (1310 nm)
Insertion loss (MM)	Typical Insertion Loss -1,0dB (1300 nm) Maximum Insertion Loss -1,5dB (1300 nm)
Return loss (PDL)	>35dB at 1310nm or 1550nm Polarization dependent loss less than 0,5dB

MECHANICAL

Coupling type	Hermaphroditic
Compliant	ROHS & REACH
Material	Hard anodized aluminum (MIL-A-8625 TYPE III CLASS 2)
Alternative material	Marine bronze, stainless steel or titanium
Colour	Grey
Durability	3000 mating cycles (MIL-DTL-83526)
Free fall	500 falls from 1,2 meters height (IEC 68-2-32-P II)
Vibration	5-500Hz, 0,75mm amplitude at 10G
Shaking	390 m/S numbers of shakes 3x4000
Shock pulse length	11ms, half sine at 35g Numbers of axis: 3 (x, y, z)
Recommended wall thickness	2-3 mm - not valid for cable plug JR and Mini

ENVIRONMENTAL

Operating temperature	-57°C to +85°C,
Water immersion	IP67
Air pressure	<25kPa -55°C during 4h
Corrosion resistance	500h salt spray
Flammability	DOD-STD-1678, method 5010

V3.1, 2025-10-09



MORE INFORMATION